

Installation, Operation and Maintenance Instructions for  
VD Series Duplex Strainer

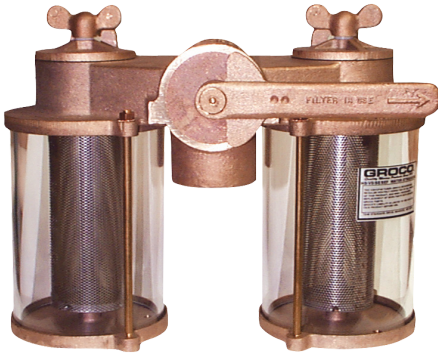

**Options:** The standard filter basket has 2mm perforations (.077"). Other perforation sizes or finer mesh options are available. Consult GROCO strainer service noted at page bottom.

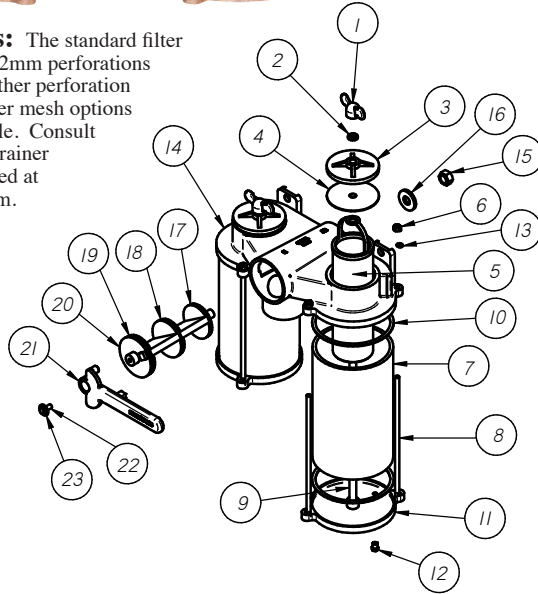

ITEM	DESCRIPTION	QTY	VD-1000	VD-1250	VD-1500	VD-2000	VD-2500	SERVICE KIT
1	WINGNUT	2	SVS-5	SVS-5	S-75	S-75	S-75	
2	WASHER	2	500-K	500-K	504-F	504-F	504-F	X
3	COVER	2	S-75I	S-75I	S-86	S-86	S-86	
4	GASKET	2	S-75I-A	S-75I-A	S-86-A	S-86-A	S-86-A	X
5	BASKET, POLY	2	BP-3	BP-5	BP-6	BP-16	BP-18	
	BASKET, #304 SS	2	BS-3	BS-5	BS-6	BS-16	BS-18	
	BASKET, MONEL	2	BM-3	BM-5	BM-6	BM-16	BM-18	
6	NUT	4	1420HS	1420HS	51618HS	51618HS	51618HS	
7	SIGHT GLASS	2	S-77	S-77-A	S-88	S-88-A	S-88-B	
	ENCLOSURE, #316 SS	2	AS-77	AS-77-A	AS-88	AS-88-A	AS-88-B	
8	TIE ROD, OUTSIDE	4	S-73-X	S-73-B	S-82-B	S-82-C	S-82-D	
9	TIE ROD, CENTER	2	S-73-D	S-73-E	S-82-E	S-82-F	S-82-G	
10	GASKET	4	#8R SET	#8R SET	#10R SET	#10R SET	#10R SET	X
11	END CAP	2	S-73-A	S-73-A	S-82-AB	S-82-AB	S-82-AB	
12	DRAIN PLUG	2	1827HB	1827HB	1827HB	1827HB	1827HB	
13	WASHER	4	14SS	14SS	516SS	516SS	516SS	
14-23	BODY-PLUG ASSEMBLY	1	VD-1000 BPA	VD-1250 BPA	VD-1500 BPA	VD-2000 BPA	VD-2500 BPA	
14	BODY (NOT SOLD)	1	VD-1000-B	VD-1250-B	VD-1500-B	VD-2000-B	VD-2500-B	
15	NUT	1	1220HB	1220HB	5818HB	5818HB	5818HB	
16	WASHER	1	VD-A	VD-A	VD-B	VD-B	VD-B	
17	O-RING	1	2-218	2-218	2-229	2-229	2-234	X
18	O-RING	1	-	-	2-231	2-231	2-236	X
19	O-RING	1	2-222	2-222	2-234	2-234	2-240	X
20	PLUG (NOT SOLD)	1	VD-1001	VD-1001	VD-1501	VD-1501	VD-2501	
21	HANDLE	1	-	-	VD-2502	VD-2502	VD-2502-A	
22	BOLT	1	-	-	51618X34HB	51618X34HB	51618X34HB	
23	WASHER	1	-	-	24L	24L	24L	
X	SERVICE KIT		VD-1	VD-1	VD-2	VD-2	VD-3	
NS	CAPTIVE COVER KIT		-	-	VD-2599	VD-2599	VD-2599	

VD-2599 COVER FITS VD-1500, VD-2000 AND VD-2500 STRAINERS AND REPLACES ITEMS 1-4 TO PROVIDE IMPROVED SEALING WHILE SECURING THE COVER ASSEMBLY TO THE STRAINER DURING SERVICE.

## INSTALLATION, OPERATION AND MAINTENANCE

**Installation:** Installation can be above (recommended) or below the waterline. The installation location should allow space for filter basket removal, 180-degree valve handle rotation and access to the drain plugs for winterization. Fasten the strainer to a bulkhead or stringer with the brackets cast into the valve body and end caps.

**Plumbing:** Inlet and outlet ports are marked on the valve body. Ports are threaded NPT. Use threaded pipe or pipe-to-hose fittings such as GROCO PTH (straight standard flow), PTHC (90-degree standard flow), PTHD (45-degree standard flow), FF (straight full flow) or FFC (90-degree full flow) for plumbing connections.

**Bonding:** Connect the strainer to the vessel bonding system with 14 AWG or larger stranded copper wire. DO NOT share the strainer bonding connection with the grounding of motorized equipment.

**Operation:** The valve handle points to the filter chamber in use. Rotate the handle 180-degrees to place the other filter chamber into service. **Note:** During service, if the strainer is below the waterline, the seacock is open and the cover is removed, some leakage from the filter chamber is normal.

**Maintenance:** Only the filter chamber that is not in use may be serviced. DO NOT loosen the outside tie rods. To access the filter basket, spin off the wingnut and remove the cover plate.

**Note:** Optional VD-2599 Cover Kit fits VD-1500, VD-2000 and VD-2500 series strainers. The kit provides improved cover sealing and tethers the cover plate to the strainer to prevent accidentally dropping the cover into the bilge during service.

**Winterization:** Close the seacock and remove both drain plugs, cover plates and connecting plumbing to completely drain the strainer to prevent damage during freezing conditions.

© 2023 GROSS MECHANICAL LABORATORIES; ALL RIGHTS RESERVED