

ARG Series Raw Water Strainers Installation and Maintenance

Installation Consideration: Strainers are usually installed below the waterline where pump priming is easier, hose runs are shorter and air leaks are minimized. However, a vertical installation above the waterline location reduces the possibility of water leaks and simplifies routine maintenance. GROCO strainers may be installed in either location. 1/2" to 1-1/4" have a separate upper bracket; fasten the bracket to a sturdy surface, then hang the strainer in the bracket to mark the position of the lower bracket (1" above the drain plug). Remove the strainer from the upper bracket to drill the holes for the lower bracket. Mount the lower bracket open-side up. Hang the strainer in the upper bracket (sight glass resting against the lower bracket pad). Run the releasable strap around the sight glass, engaging the lower bracket, and pull hand-tight.



ARG-P SERIES
Non-metallic basket

1-1/2" strainers and larger do not have a separate upper bracket. Bolt through the cast-in bracket and into a bulkhead or stringer. Install the lower bracket and releasable strap as described above.

Bonding: Use one of the #10 screws on the strainer head to connect to the vessel bonding system. DO NOT make the strainer bonding connection in series with other motorized equipment (referred to as "daisy-chaining") as specified by ABYC, E-11.

Maintenance: Inspect and clean the basket frequently. Clean the sight glass with mild soapy water. Do not use chemical cleaners. After servicing replace the cap hand-tight only. Use GROCO SW-2531 to loosen the cap if stuck.

SERVICE NOTES:
Do not exceed 25 in-lb torque when tightening sight glass bolts.

Lubricate cap threads and O-Rings annually with Teflon or Silicon Grease

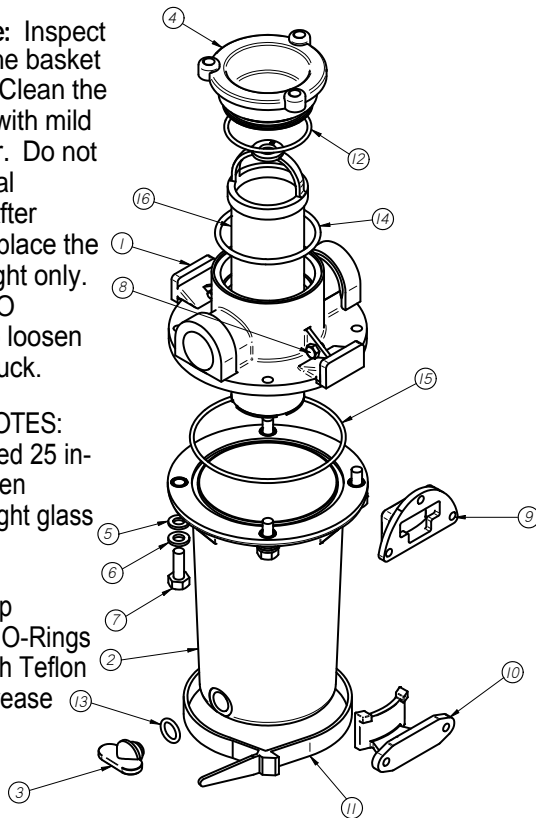

ITEM NO	NAME	IN SVC KIT	QTY	ARG-750	ARG-755	ARG-500	ARG-504	ARG-502	ARG-1500	ARG-2015	ARG-2000	ARG-2515	ARG-2520	ARG-2500	ARG-3015	ARG-3020	ARG-3025	ARG-3000
1	Head Casting	ARG-510-H	1	ARG-760-H	ARG-760-H	ARG-510-H	ARG-504	ARG-502	ARG-1500	ARG-2010-H	ARG-2010-H	ARG-2510-H	ARG-2510-H	ARG-2510-H	ARG-3010-H	ARG-3010-H	ARG-3010-H	ARG-3010-H
2	Sight Glass	ARG-503	1	ARG-503	ARG-503	ARG-503	ARG-503	ARG-502	ARG-1503	ARG-1503	ARG-2003	ARG-1503	ARG-2003	ARG-2503	ARG-1503	ARG-2003	ARG-2503	ARG-5003
3	Drain Plug W/O-RING	ARG-756	1	ARG-756	ARG-756	ARG-756	ARG-756	ARG-505	ARG-756	ARG-756	ARG-756	ARG-756	ARG-756	ARG-756	ARG-756	ARG-756	ARG-756	ARG-756
4	Drain Plug W/O-RING before 080101	ARG-506	1	ARG-506	ARG-506	ARG-506	ARG-506	ARG-502	ARG-506	ARG-506	ARG-506	ARG-506	ARG-506	ARG-506	ARG-506	ARG-506	ARG-506	ARG-506
4	Cap, Plastic	ARG-501-PC	1	ARG-501-PC	ARG-501-PC	ARG-501-PC	ARG-501-PC	ARG-502	ARG-1001-PC	ARG-1001-PC	ARG-1001-PC	ARG-1001-PC	ARG-1001-PC	ARG-1001-PC	ARG-1001-PC	ARG-1001-PC	ARG-1001-PC	ARG-1001-PC
4	Cap, Bronze, before 010901	ARG-501-B	1	ARG-501-B	ARG-501-B	ARG-501-B	ARG-501-B	ARG-502	ARG-1001-B	ARG-1001-B	ARG-1001-B	ARG-1001-B	ARG-1001-B	ARG-1001-B	ARG-1001-B	ARG-1001-B	ARG-1001-B	ARG-1001-B
4	Cap, Bronze, after 010901	ARG-501-C	1	ARG-501-C	ARG-501-C	ARG-501-C	ARG-501-C	ARG-502	ARG-1001-C	ARG-1001-C	ARG-1001-C	ARG-1001-C	ARG-1001-C	ARG-1001-C	ARG-1001-C	ARG-1001-C	ARG-1001-C	ARG-1001-C
5	Washer	ARG-1	1	ARG-2	ARG-2	ARG-2	ARG-2	ARG-2	ARG-3	ARG-3	ARG-3	ARG-3	ARG-3	ARG-3	ARG-3	ARG-3	ARG-3	ARG-3
6	Washer	ARG-1	4	14SS	14SS	14SS	14SS	14SS	14SS	14SS	14SS	14SS	14SS	14SS	14SS	14SS	14SS	14SS
7	Hex Bolt	ARG-1	4	1420X34HS	1420X34HS	1420X34HS	1420X34HS	1420X34HS	1420X34HS	1420X34HS	1420X34HS	1420X34HS	1420X34HS	1420X34HS	1420X34HS	1420X34HS	1420X34HS	1420X34HS
8	Hex Bolt	ARG-1	2	1024X14HB	1024X14HB	1024X14HB	1024X14HB	1024X14HB	1024X14HB	1024X14HB	1024X14HB	1024X14HB	1024X14HB	1024X14HB	1024X14HB	1024X14HB	1024X14HB	1024X14HB
9	Bracket, Upper	ARG-1	1	ARG-505	ARG-505	ARG-505	ARG-505	ARG-505	ARG-1005	ARG-1005	ARG-1005	ARG-1005	ARG-1005	ARG-1005	ARG-1005	ARG-1005	ARG-1005	ARG-1005
10	Bracket, Lower	ARG-1	1	ARG-504	ARG-504	ARG-504	ARG-504	ARG-504	ARG-1004	ARG-1004	ARG-1004	ARG-1004	ARG-1004	ARG-1004	ARG-1004	ARG-1004	ARG-1004	ARG-1004
11	O-Ring	ARG-1	1	2-135	2-135	2-135	2-135	2-135	2-229	2-229	2-229	2-229	2-229	2-229	2-229	2-229	2-229	2-229
12	O-Ring	ARG-1	1	2-111	2-111	2-111	2-111	2-111	2-111	2-111	2-111	2-111	2-111	2-111	2-111	2-111	2-111	2-111
13	O-Ring	ARG-1	1	2-011	2-011	2-011	2-011	2-011	2-011	2-011	2-011	2-011	2-011	2-011	2-011	2-011	2-011	2-011
14	O-Ring before 080101	ARG-1	1	2-228	2-228	2-228	2-228	2-228	2-232	2-232	2-232	2-232	2-232	2-232	2-232	2-232	2-232	2-232
15	O-Ring	ARG-1	1	2-153	2-153	2-153	2-153	2-153	2-157	2-157	2-157	2-157	2-157	2-157	2-157	2-157	2-157	2-157
16	Basket, Polyethylene	BP-1	1	BP-1	BP-1	BP-1	BP-1	BP-1	BP-4	BP-4	BP-4	BP-4	BP-4	BP-4	BP-4	BP-4	BP-4	BP-4
16	Basket, #304-SS	BS-1	1	BS-1	BS-1	BS-1	BS-1	BS-1	BS-5	BS-5	BS-5	BS-5	BS-5	BS-5	BS-5	BS-5	BS-5	BS-5
16	Basket, Monel	BM-1	1	BM-1	BM-1	BM-1	BM-1	BM-1	BM-4	BM-4	BM-4	BM-4	BM-4	BM-4	BM-4	BM-4	BM-4	BM-4